

Find the center line and measure 950 mm from the center line.
Remove the screw from the middle (from the wall board jig).
Remove the screws from the edge (screw locations may vary depending on the wall construction).
Remove the board!

* Only from the last wall board!

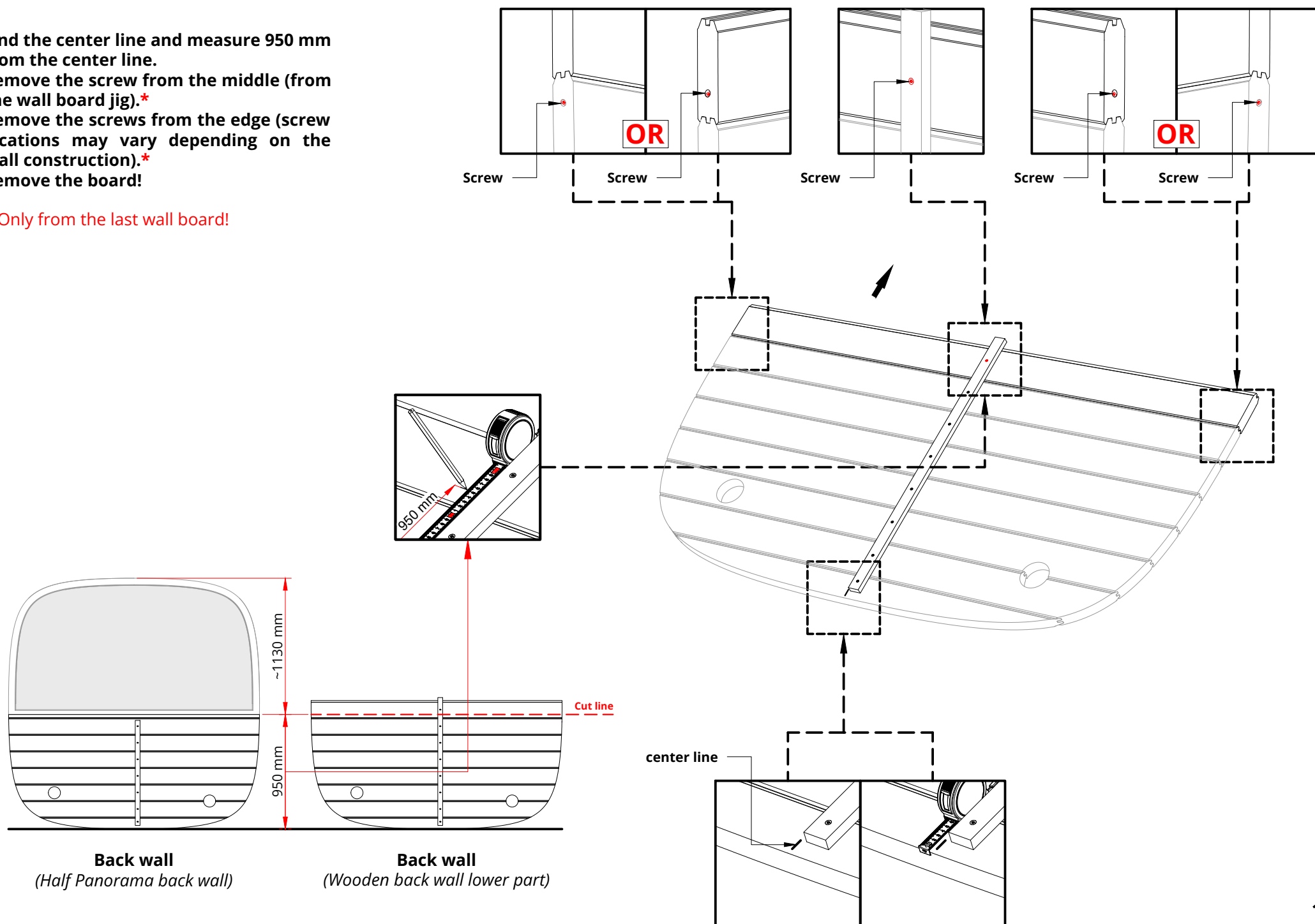

Please countersink the screw head(s)!

Measure the distance from the bottom edge of the board to the previously marked line.

Mark the measurements on both ends.

Connect the marked measurements with a line and then cut the board.

Screw the board back to the wall with 6 screws.*

Cut the wall jig shorter (Recommended).

*Drill holes for screws, otherwise which the wood may crack.

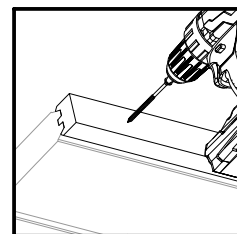
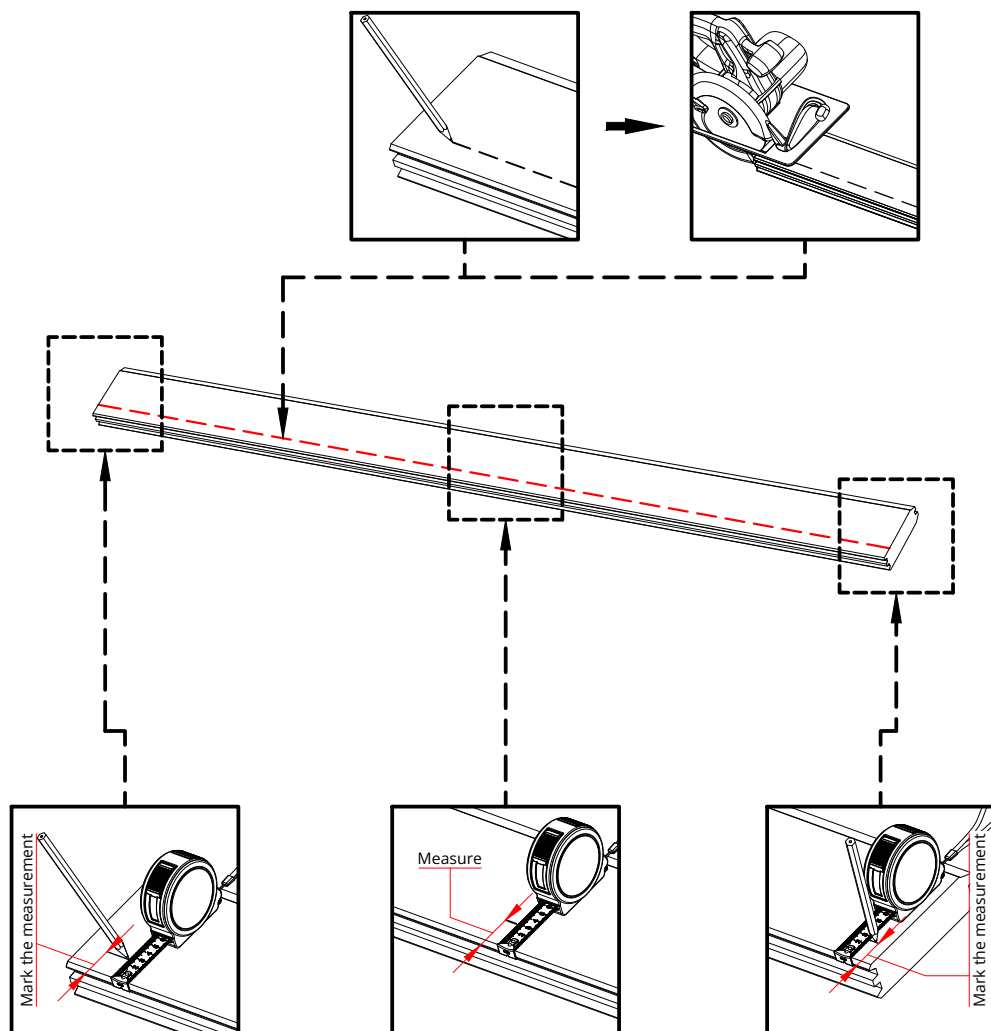

Notice!

Drill small hole(s) for the screws.

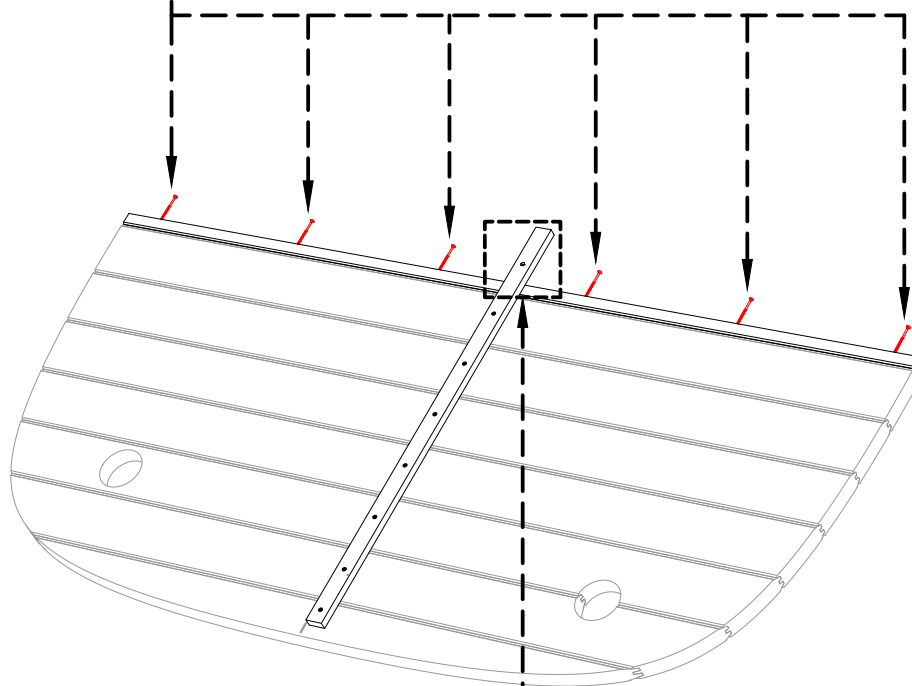
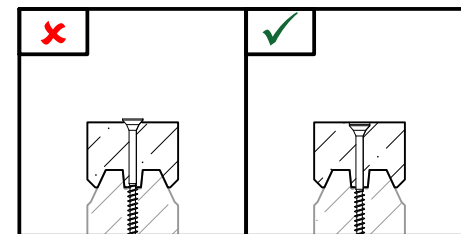

Recommended!

Cut the wall jig shorter.

